



# HOLE ROUGHENER KIT

With corehole brush, carbide tips and flexible shaft, AllFasteners Hole Cleaning and Roughening System has a substantial impact on overall performance. Use in conjunction with AllFasteners AF35LVE epoxy for superior bond.



## ADVANTAGES

- Works in a range of hole sizes (2"-2¾")
- Preps hole for increased bond strength of epoxy
- Flexible shaft
- Long lasting carbide tips and nylon brush
- Quick disconnect
- Operator friendly

## SPECIFICATIONS

- Flexible shafts up to 30ft.
- Includes 850 rpm Milwaukee™ drill
- Heavy duty
- Design for diamond cored holes

## PRODUCT INFORMATION

PART #	DESCRIPTION
9HR-14	14 ft. Flexbile Shaft Deep Hole Roughener Kit
9HR-20	20 ft. Flexbile Shaft Deep Hole Roughener Kit
9HR-30	30 ft. Flexbile Shaft Deep Hole Roughener Kit



# HOLE ROUGHENER KIT

## PARTS LIST

This guide shows all replacement and additional parts available for the AF Hole Roughener Kit. Ask a sales rep. for more information.

- A. Small Roughener Bit (1-1/2" - 2")
- B. Large Roughener Bit (2"-2 3/4")
- C. Brush
- D. Brush Quick Tip
- E. Flex Shaft (14')
- F. Flex Shaft (20')
- G. Flex Shaft (30')
- H. Milwaukee™ Electric Drill 110v
- I. Pelican™ Storage Case



**B. ALSO AVAILABLE IN  
LARGE SIZE (2"-2 3/4")**



**F. ALSO AVAILABLE IN 20' LENGTH**

**G. ALSO AVAILABLE IN 30' LENGTH**



## INSTRUCTIONS & USE



1 Remove the flex shaft from case.

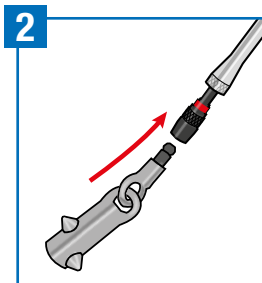

2 Install the roughener bit to the flex shaft.

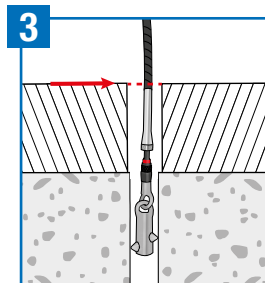

3 Insert the roughener bit and shaft into the hole to be roughened past the metal end.

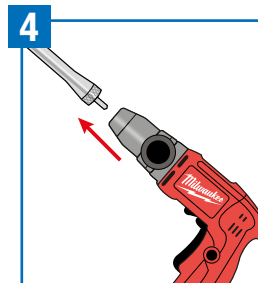

4 Remove drill from case and install the drive end of the shaft into the drill.

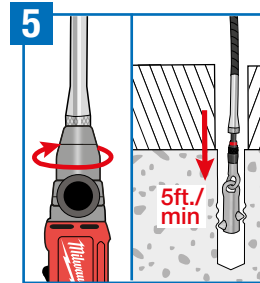

5 While running the drill (clockwise/forward) slowly lower or insert the roughener into the hole at a rate of approximately 5ft./min.

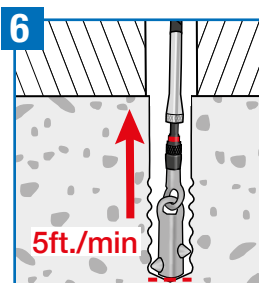

6 When the roughener reaches the bottom of the hole, slowly raise the roughener at approximately 5ft./min.

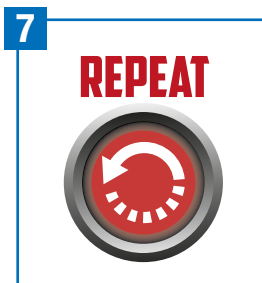

7 Repeat steps 5 and 6 until the desired roughness is achieved.

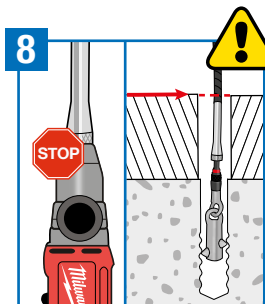

8 Caution! Do not remove the roughener while it is running.

Stop the drill before the metal end of the shaft is exposed at the top of hole.

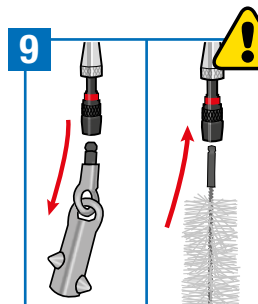

9 Caution! Disconnect power from drill before installing or removing the roughener bit or brush attachment.

Remove the roughener attachment and install the brush attachment.

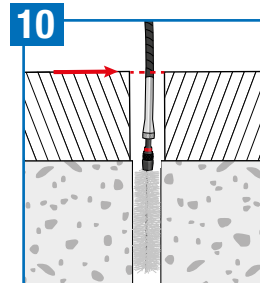

10 Insert the brush and shaft into the hole to be cleaned past the metal end.



## INSTRUCTIONS & USE (CONT'D)

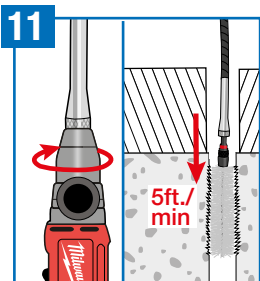

While running the drill (clockwise/forward) slowly lower or insert the brush into the hole at a rate of approximately 5ft/min.

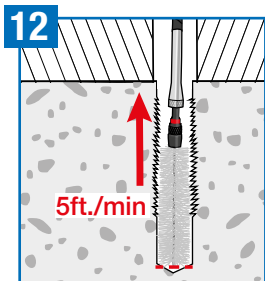

When the brush reaches the bottom of the hole slowly raise the brush at a rate of approximately 5ft/min.

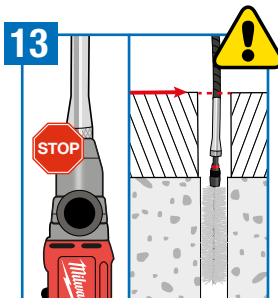

Caution! **DO NOT** remove the brush from the hole while it is running.  
  
Stop the drill before the metal end of the flex shaft is exposed at the top of the hole.



Caution! Disconnect power from drill when installing or removing the roughener bit or brush attachment.  
  
Remove the drill from the drive end of the flex shaft.

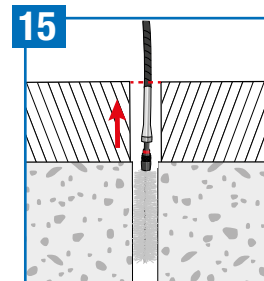

Remove the flex shaft and attachment from hole.

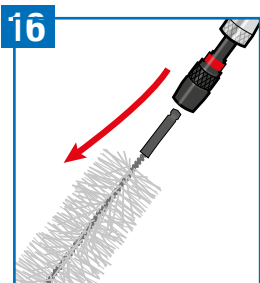

Remove the brush attachment.



Clean and place all components back into the carry case.

### • WARNINGS

- **DISCONNECT POWER** from the drill when installing or removing the roughener bit or brush attachments
- **ONLY USE THE DRILL PROVIDED.** Running the flex shaft at higher speeds will damage the shaft.
- **DO NOT** start the drill until the roughener is inserted in the hole at least 12". Running the drill with the roughener out of the hole may cause injury or death.